



TECHNICAL DATA SHEET

WINDOW & DOOR

Expanding Polyurethane Foam Sealant

WINDOW & DOOR is specifically formulated for filling, insulating, and sealing around windows and doors. Innovative low pressure and expansion formula eliminates warping or bowing of frames, and provides a full cavity fill.

Conforms to the shape of all cavities forming a permanent, airtight, and waterproof seal on wood, metal, masonry, glass, and most plastics. It stops air infiltration and, in turn, prevents heat loss and drafts. TYTAN WINDOW & DOOR is environmentally friendly, contains no CFC's or HCFC's, and it is UL Classified.

FEATURES

- Expands to fill gap without bending, warping, or bowing window and door frames
- Professional low pressure, low expansion formula to fill, seal, and insulate between window and door frames and their rough openings
- AAMA Verified Component – Exceeds **AAMA 812** Requirements.
- All-Direction Dispensing – More Comfortable Application in Places that are Hard to Reach
- Bonds and seals to common construction materials: wood, concrete, plaster, etc. controllable, quick, and efficient application
- Repels and blocks moisture
- Durable airtight seal – bonds, stops heat loss, and air infiltration
- High long term insulation value - increases energy efficiency
- Easier to transport and use than fiberglass
- Shelf life 18 months



TYPICAL APPLICATIONS

Wide range of interior and exterior sealing and insulating applications such as basement areas, attic areas and around cables, pipes, vents and duct penetrations:

- For interior and exterior window & door installations
- For filling and sealing all interior and exterior building gaps, cracks, and openings

TECHNICAL DATA

Base	polyurethane
Type	foam sealant
Appearance	foam
Color	pale yellow
Solvent before cure	acetone
Odor	odorless when cured
Application temperature	41°F- 86°F / 5°C - 30°C
Can temperature	min. 50°F/ 10°C
Tack-free time	≤10 min.,
Cutting time 1"	≤60 min., max 24 hrs
Cure	in 6 h, fully cured after 24 hrs
Service temperature after curing	-76°F to 212°F / -60°C to 100°C
Shrinkage	≤ 5 %, after first 24 hrs
Water absorption	≤ 1,5% after first 24 hrs then waterproof
% Closed cell content	up to 50%
Thermal Conductivity	0.036 W/mK
R Value[Tpically]	4-5 per inch





TECHNICAL DATA SHEET

Product size		Yields				
[oz]	[g]	[liter]	cu ft	1/2" [ft]	3/8" [ft]	1/4" [ft]
17	480	25 - 30	0.88 - 1.06	646 [ft] / 196 [m]	1,149 [ft] / 350 [m]	2,585 [ft] / 787 [m]
9	255	12 - 17	0.42 - 0.60	311 [ft] / 94 [m]	553 [ft] / 168 [m]	1,243 [ft] / 378 [m]

All communicated parameters were measured in compliance with Selena's internal standards and depend heavily on external curing conditions, equipment quality, and adherence to application instructions. The parameters were measured in standard laboratory conditions at +73 °F (+23 °C) and 50% RH. Yield results are based on theoretical calculations for comparative analysis purposes. Results may vary depending on ambient conditions and particular application.

UL Classified

Caulking and Sealants Applied to Inorganic Reinforced Cement Board+
<75NN>

SURFACE BURNING CHARACTERISTICS

Flame Spread: 0

Smoke Developed: 10

* Three nominal 19 mm diameter beads applied to inorganic cement board spaced 125 mm OC covering 12.5% of the exposed test area

NFPA 30B Classification: Level 3 Aerosol

APPLICATION INSTRUCTION

Always read all operating, application, and safety instructions before using any products from Selena Group. Use in conformance with all local, state, and federal regulations and safety requirements. Read all product directions and safety information before use.

Preparation

1. Product **FLAMMABLE DURING DISPENSING**.
2. Wear protective clothes, gloves, and eye protection. Use only in well ventilated area or wear approved respiratory equipment. Contact and application areas should be dry, clean, free of dust, oil, grease or any foreign objects, debris and contaminants that could interfere with proper adhesion. Clean and degrease surface with TYTAN™ Cleaner, acetone, isopropanol, ethanol (metals, glass) or detergent (plastics), and let it dry completely. Surfaces must be sound and in good condition. It is recommended to lightly spray surfaces with water prior to applying foam to enhance expansion and curing properties.
3. For best results and maximum yield, apply at temperatures 50°F to 86°F/ 10°C - 30°C. Use below 41°F / 5°C is not recommended.
4. Shake the can vigorously for 30-45 seconds before attaching trigger and also in-between uses.
5. Remove protective cap, screw trigger and straw onto valve.

Application

1. Maintain the can in upside-down, inverted position during the application. All-Direction Dispensing possible when content temp > 59°F/ 15°C.
2. Point straw in safe direction and slowly pull trigger to test dispense foam.
3. Fill cavities to approximately 50% full to allow for foam expansion after application. Cracks wider than 2" should be filled gradually in layers.
4. Trim excess foam with sharp knife or serrated edge. Cured foam may be sanded, painted, or stained (not before 24 hrs. after application). Cured foam discolors and loses its stability and properties when exposed to UV light. Paint or coat exposed foam for best results.
5. If idle for 10 or more minutes between uses, shake can vigorously 30-45 seconds before reusing.
6. When not in use, can valve should be cleaned with TYTAN CLEANER.

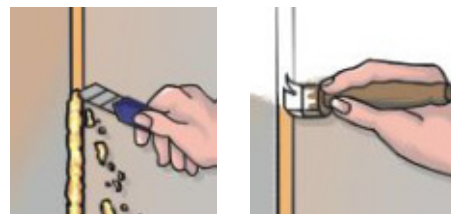
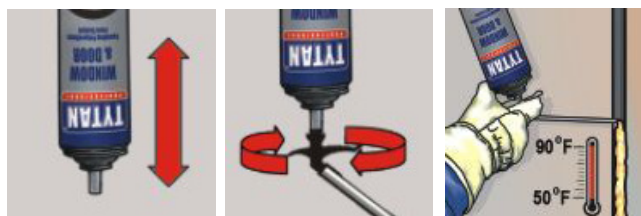



TECHNICAL DATA SHEET

Cleaning

1. Uncured Foam – Clean immediately with TYTAN CLEANER or acetone.
2. Cured Foam - if hardened on skin - use an industrial cleaner with pumice. Repeat process until foam is removed. Cured foam must be mechanically removed or allowed to wear off in time.

SHELF LIFE, STORAGE AND LOGISTIC

When stored properly, shelf life is **18 months** from production date, printed on the bottom of each can. Store upright in cool and dry area at temperatures 41°F to 86°F/ 5°C to 30°C. Do not expose to open flame or temperatures above 120°F/ 50°C. Keep away from open flame.

Product code	Size	Packaging	Case Pack
5898	17 Oz. (480 g)	Aerosol Can	12
5897	9 Oz. (255 g)	Aerosol Can	12

SAFETY AND WARRANTY

SAFETY: HARMFUL CONTENTS UNDER PRESSURE. **Contents may burst if left in areas susceptible to extremely high temperatures. Do not place in Hot water.** DO NOT PLACE OR STORE IN A CLOSED AREA SUCH AS A CAR. USE ONLY IN WELL VENTILATED AREAS. AVOID CONTACT WITH SKIN OR EYES. WEARING PROTECTIVE EYEWEAR AND GLOVES IS RECOMMENDED. DO NOT BREATHE VAPOR/SPRAY. DO NOT INCINERATE, PUNCTURE, OR EXPOSE CAN TO DIRECT SUNLIGHT FOR LONG PERIODS OR STORE AT TEMPERATURES OVER 120°F/50°C. **KEEP OUT OF REACH OF CHILDREN.**

FIRST AID: In case of eye contact, flush **immediately** with water for 15 minutes and **get medical help**. If inhalation causes physical discomfort, move to fresh air. If discomfort persists or any breathing difficulty occurs, **get medical help**. If swallowed, drink large quantities of water. DO NOT induce vomiting. **GET PHYSICIAN ASSISTANCE IN ALL CASES.** Cured foam is not harmful to health.

INGREDIENTS: polymeric diisocyanate, polyols, hydrocarbon gas mixture.

Always read all operating, application, and safety instructions before using any products from Selena USA, Inc. Use in compliance with all local, state, and federal regulations and safety requirements. Read all product directions and safety information before use.

DISPOSAL OF PRODUCT AND CONTAINERS: Each person, firm, or corporation engaged in the application, installation, disposal, or any other use of these materials shall carefully and precisely determine all potential hazards associated with such products in specific usage, and utilize all appropriate precautionary and safety measures as outlined in local, state, and federal regulations governing the use or disposal of product or empty containers.

LIMITED WARRANTY: Selena USA, Inc warrants its products to be free of manufacturing defects due to workmanship and materials for the duration of and in accordance to the conditions stated in the individual Technical Data Sheets. This warranty is limited to the replacement of the product when such product proves to be defective in manufacture. This express warranty will only apply if the product is stored as specified and used in accordance for its intended purposes. It does not apply to failures due to improper application. Selena USA, Inc. disclaims all other warranties, expressed or implied, as well as liability for any incidental or consequential damages. The liability extent of both manufacturer and seller is limited to replacement of product only.

With the publication of this Technical Data Sheet, previous editions are no longer valid. Due to continuous product and process improvements, specifications and prices are subject to change without notice.

The company shall not be liable, in any event for any incidental, consequential, special, or indirect damages or damages to a structure or its contents from any cause whatsoever. This warranty may not be modified or amended by any employee, representative agent or customer of Selena USA, Inc. This warranty is exclusive and is in lieu of all other warranties, express, or implied, including any implied warranty of merchantability or fitness for particular purpose. The extent of liability for breach of such warranty is limited to replacement of product only.