

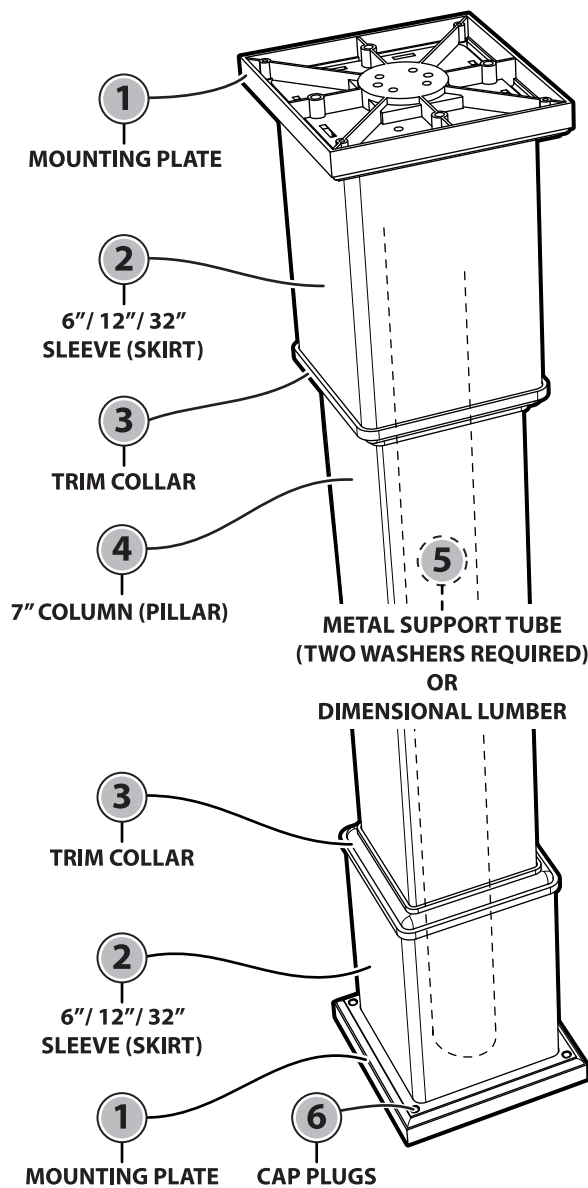

7" SQUARE PORCH COLUMN (PILLAR) INSTALLATION GUIDE

COLUMN COMPONENTS

(Internal support and fasteners are not included)



Alpa Ontario Railing Inc.
101 Glidden Road, Brampton, Ontario L6T 3W6
Tel: (905) 796-6631 Fax: (905) 796-8790

IMPORTANT REVIEW ALL INSTRUCTIONS BEFORE ASSEMBLING COLUMN

ALP-CIG-V003

STEP 1

Measure vertical opening.

For load bearing applications:

If using dimensional lumber (laminated 2"x4" shown) cut it 1" shorter than overall height.

OR

If using aluminum support tube, cut it 1-1/8" shorter than overall height.

Cut vinyl column 2-1/4" shorter than the overall height to place the entire load on the internal support and allow for thermal expansion.

STEP 2

The mounting plate, trim collar and the 6", 12" or 32" sleeve (skirt) will be pre-assembled for ease of installation.

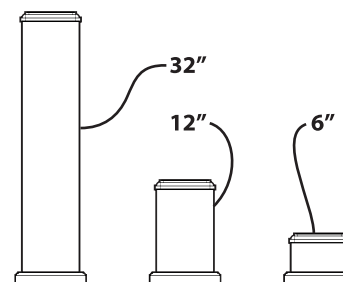

If you have received these components as separate pieces, please follow the steps outlined to the right in step 3.

ALTERNATIVE ASSEMBLY WITHOUT SLEEVE (SKIRT)

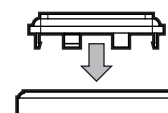

Snap into place the trim collar and mounting plate.

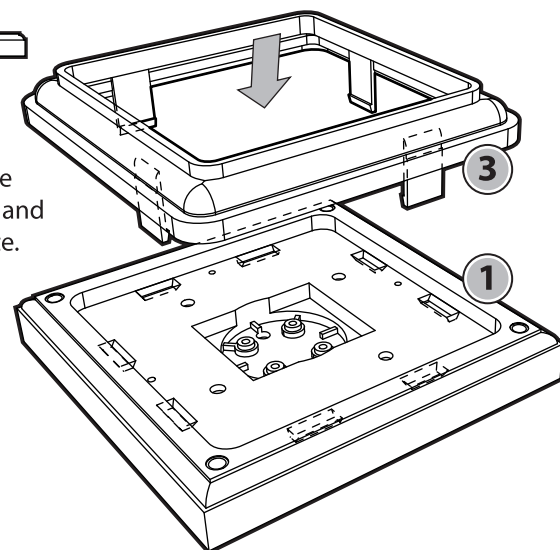

NON-LOAD BEARING INSTALLATION

For non-load bearing applications column may be used without an internal support.

STEP 3

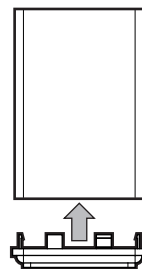

Assemble trim collar to sleeve with 1/2" screws through the 4 tabs on the trim collar and into sleeve.

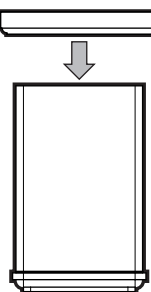
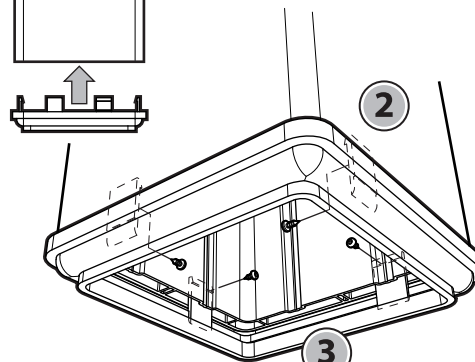

Attach mounting plate to the other end of the sleeve (skirt) with at least 2 screws.

Slide vinyl column along with the dimensional lumber or support tube into mounting plate.

When using dimensional lumber, centre it on the mounting plate.

When using a support tube, make sure that support washers are inserted into the mounting plates prior to assembly.

LOAD BEARING INSTALLATION

For load bearing applications an internal support MUST be used.

STEP 4

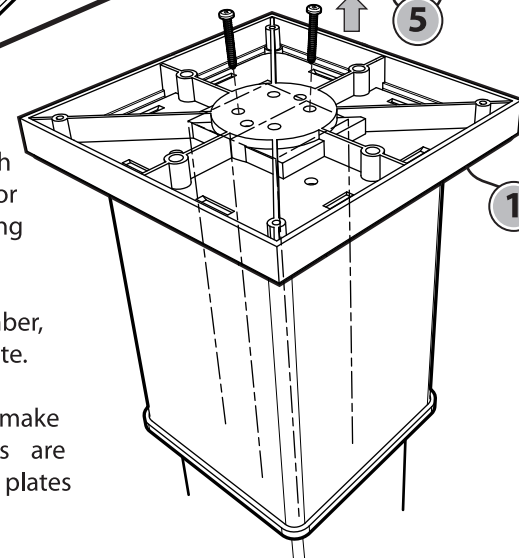
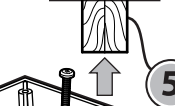
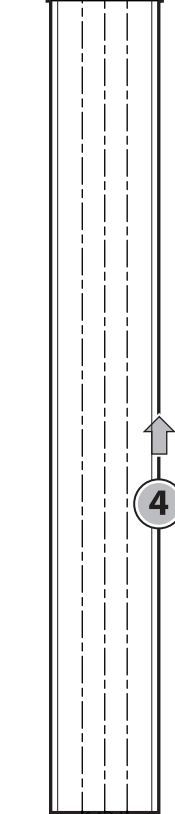
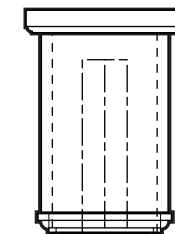

STEP 5

Attach other mounting plate assembly (steps 2 or 3) to internal support as in step 4.

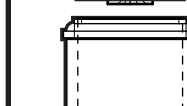
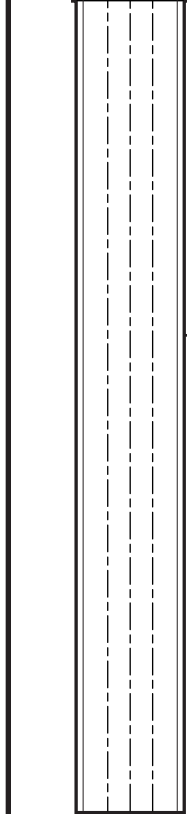
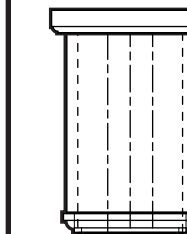

CARE & CLEANING

Ordinary dirt and mud usually washes off with a hose. At times it may be necessary to use a non-abrasive household cleaner to remove residue and then rinse with a hose.

FASTENERS

All appropriate fasteners are to be supplied by installer and be of a non-corrosive quality.

STEP 6



Set assembly in place.

Attach mounting plates to porch or ceiling with non-corrosive screws, one screw per corner.

Cover holes with cap plugs, gluing in place.

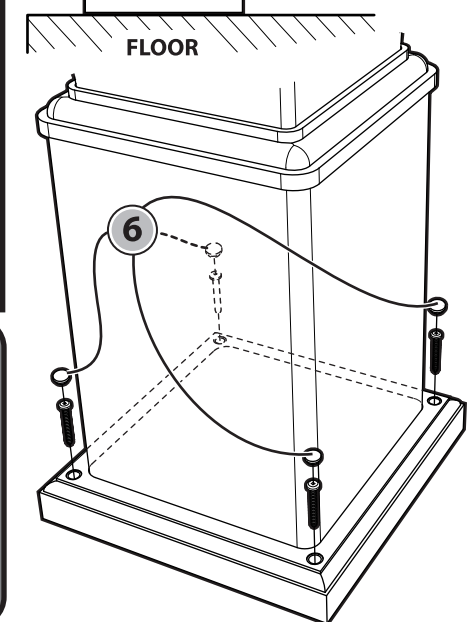



8" DIAMETER PORCH COLUMN (PILLAR) INSTALLATION GUIDE

COLUMN COMPONENTS

(Internal support and fasteners are not included)

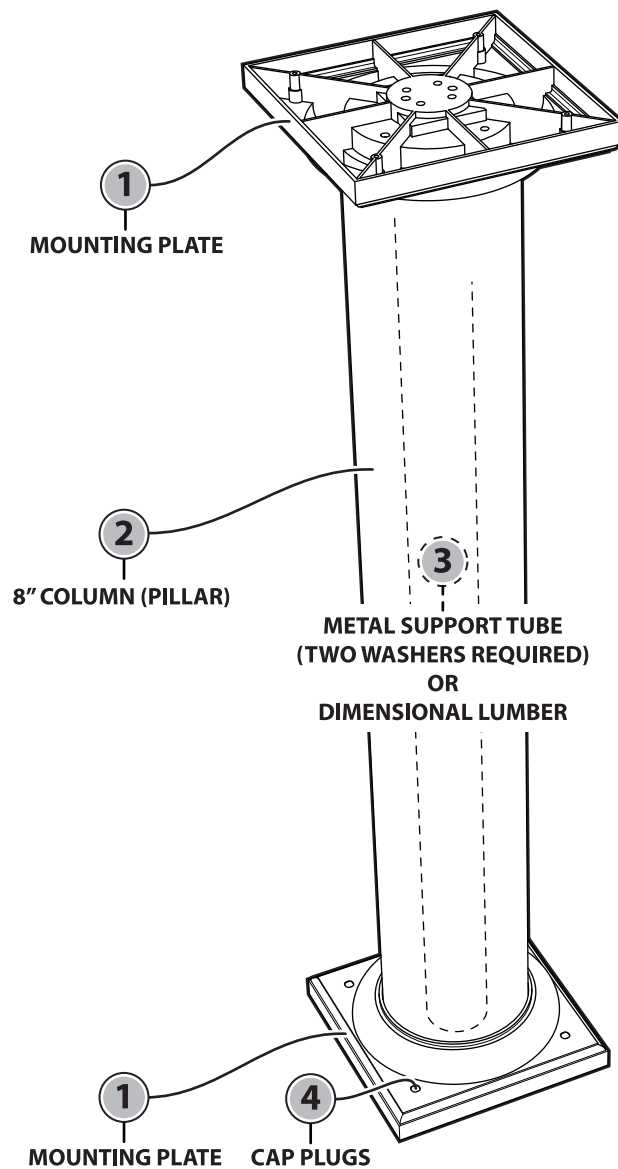

Alpa Ontario Railing Inc.

101 Glidden Road, Brampton, Ontario L6T 3W6

Tel: (905) 796-6631 Fax: (905) 796-8790

IMPORTANT REVIEW ALL INSTRUCTIONS BEFORE ASSEMBLING COLUMN

FOR NON-LOAD BEARING INSTALLATION

STEP 1

Measure vertical opening and cut column to length.

STEP 2

Assemble the top and bottom mounting plates with the column.

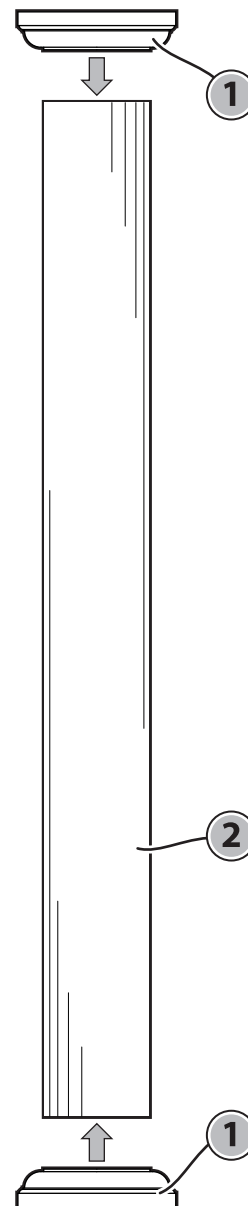

STEP 3

Please see FINAL STEP for details.

NON-LOAD BEARING INSTALLATION

For non-load bearing applications column may be used without an internal support.

FOR LOAD BEARING INSTALLATION

STEP 1

Measure vertical opening.

If using dimensional lumber (laminated 2"x4" shown) cut it 1" shorter than overall height.

OR

If using aluminum support tube, cut it 1-1/8" shorter than overall height.

Cut vinyl column 2-1/4" shorter than the overall height to place the entire load on the internal support and allow for thermal expansion.

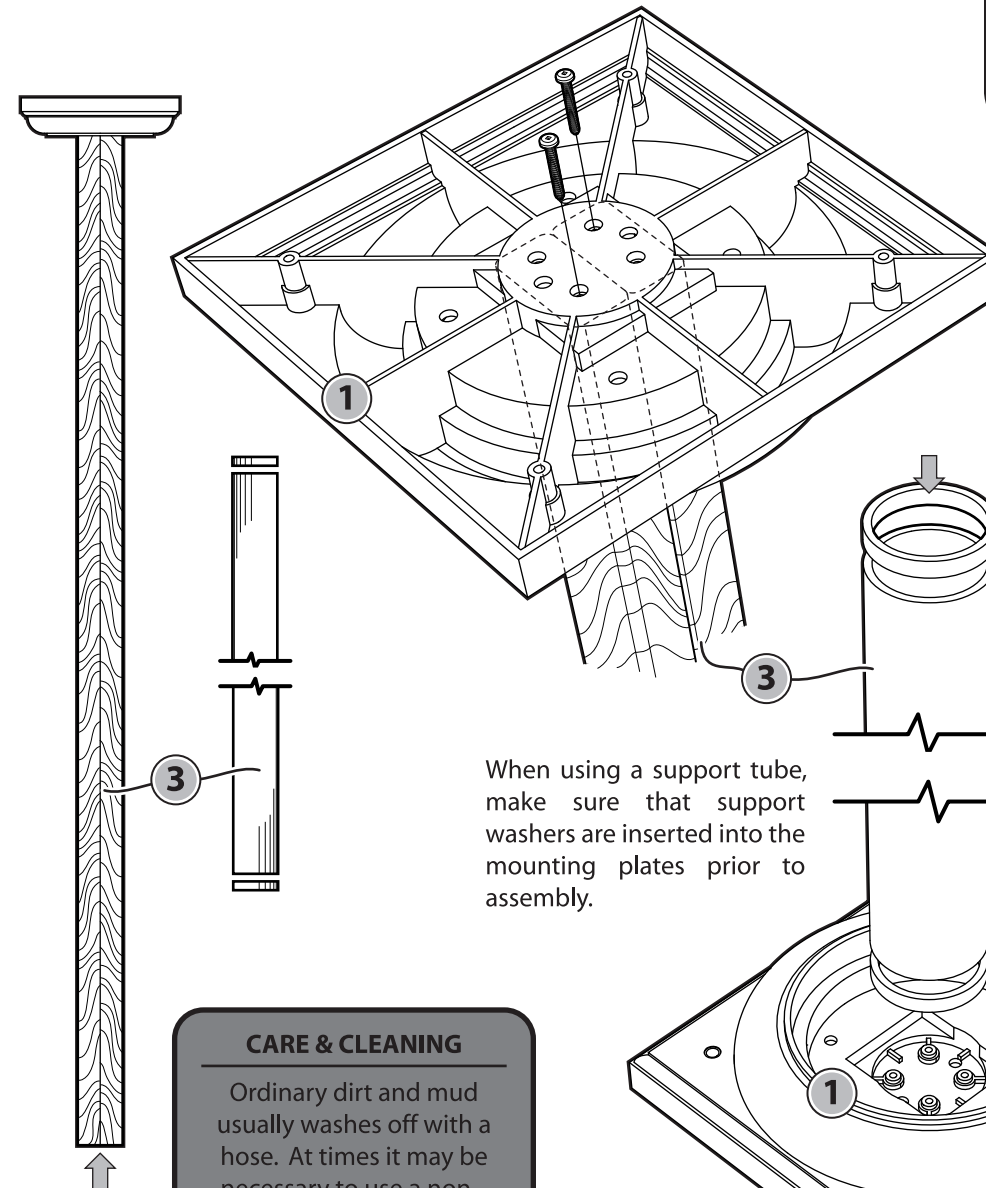

When using a support tube, make sure that support washers are inserted into the mounting plates prior to assembly.

CARE & CLEANING

Ordinary dirt and mud usually washes off with a hose. At times it may be necessary to use a non-abrasive household cleaner to remove residue and then rinse with a hose.

LOAD BEARING INSTALLATION

For load bearing applications an internal support **MUST** be used.

STEP 2

Slide column over internal support and attach remaining mounting plate to it, see previous step for details.

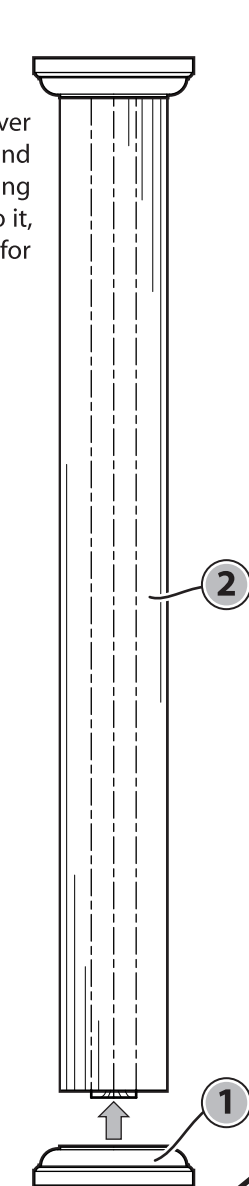

FASTENERS

All appropriate fasteners are to be supplied by installer and be of a non-corrosive quality.

FINAL STEP

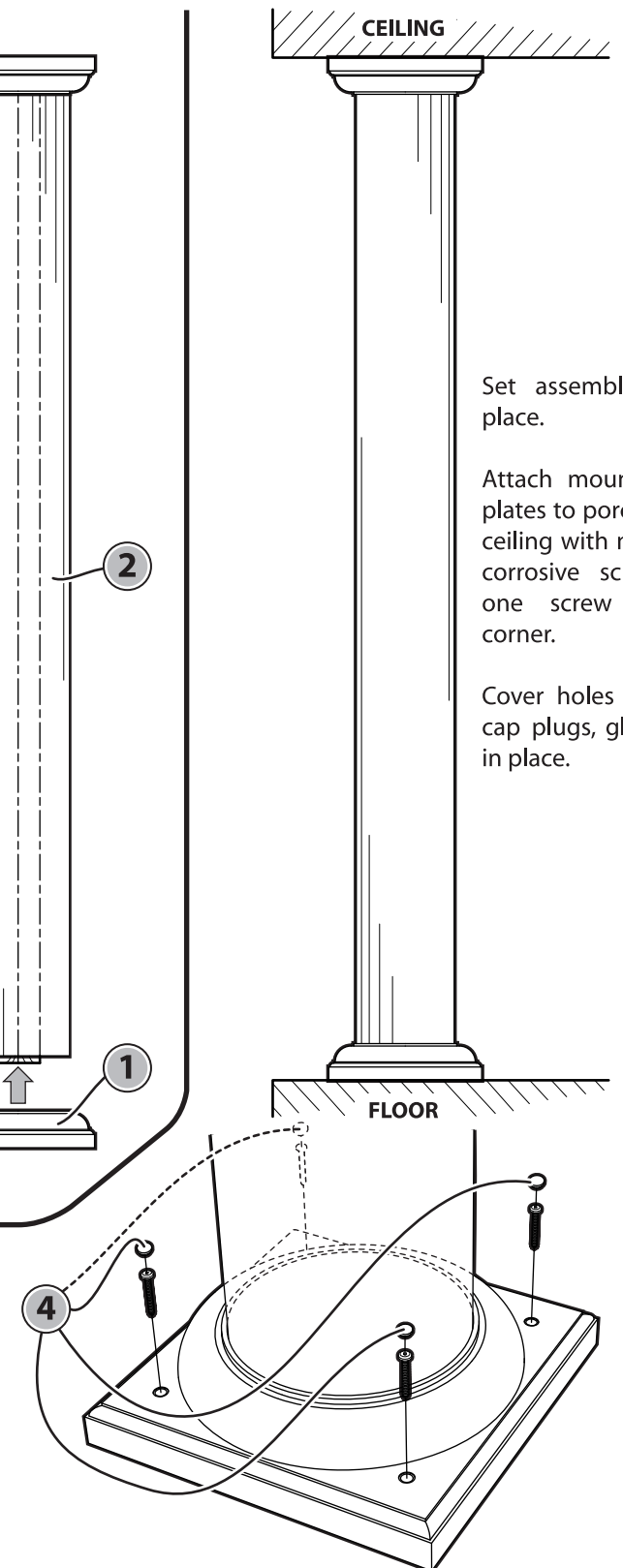

Set assembly in place.

Attach mounting plates to porch or ceiling with non-corrosive screws, one screw per corner.

Cover holes with cap plugs, gluing in place.