



Beige Granite #228



Anthracite #233



Limestone #235

With its industry-leading technology and expertise, Novik® has created dry stack stone that is lightweight and easy to install with the amazing look and feel of a dry stack stone wall.

As beautiful outside as inside, as traditional as it is contemporary, Novistone™DS - Dry Stack Stone was designed to inspire a world of possibilities no matter what your style or vision:

- Indoor and outdoor decor
- Foundations, facades, architectural accents, gazebos, hot tub sides
- Decorative interior walls, beams
- New construction or renovation, residential or commercial

/ COLORS AVAILABLE



ENHANCED PERFORMANCE FEATURES

FAST-FIT

/ What is Fast-Fit?

Features that simplify installation.



Product shown: NoviStone™ DS Limestone #235.
Overall dimensions: 41.5" x 13.13" (105,41 cm x 33,34 cm)
10 panels each box: 25.18 square feet (2,34 m²)



Inside



Outside

2 in 1 multifunctional corners:

Corners are available in all NoviStone™ DS colors.
Overall dimensions: 5.88" x 16" (14,92 cm X 40,64 cm)



Truly maintenance free.
Never needs to be painted.

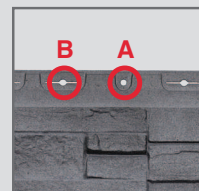

1. **A)** Center nailing hole: helps spread the panel's expansion and contraction evenly
- B)** Nail locators: facilitate the installation by precisely showing proper nail location

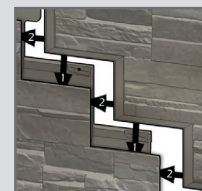

2. Staircase interlocking system: facilitates panel alignment

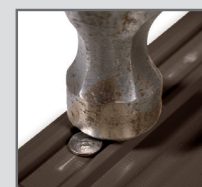
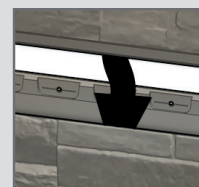

3. Continuous full panel interlocking system for secure and rapid installation
4. « Hammer-stopper » System: helps limit nail penetration to ensure smooth panel expansion and contraction

NOVISTONE PREMIUM LEDGE



- Transition between two sidings
- Available in 3 colors, fits with all types of Novik® siding: Onyx, Weathered Blend and Gray Mortar
- Decorative ledge under a window
- 3 opening options depending on the siding thickness

Corners available in matching colors :

- * Can also be used for finishing



ABOUT NOVIK®

Novik® provides beautiful shakes and stone that faithfully reproduce traditional materials at the cutting edge of technology, offering an option that is both attractive and easy to install, and provides tremendous value. Novik® products are a perfect fit for consumers who take pride in the natural beauty of their home, while demanding the freedom and lifestyle that little to no upkeep for our products provides. With Novik®, discover a multitude of possibilities for the residential and commercial construction sectors as well as the renovation industry.

For more information : www.novik.com.

PRODUCT HIGHLIGHTS

- Extreme temperature variation resistance
- Resistance to warping, expansion, contraction and cracking
- Wind and Impact (ASTM D4226) resistance
- Resistance to discoloration (U.V rays.)
- Flame spread <200
- Seamless visual appearance
- Lightweight material, fast and easy to install
- Virtually maintenance free
- Never needs to be painted
- Authentic stone texture
- Armonizes with all siding types
- Features that simplify installation **FAST-FIT**
- Certified testing by independent laboratories (ICC-ES, FBC, CCMC)

TESTS

Test	Standard testing	Result for NOVISTONE™ DS
Fire rating	In accordance with ASTM E84	Flame spread < 200
Impact	In accordance with ASTM D4226	>35 in-lbf
Weatherability	In accordance with ASTM D1435/G147	Pass
Wind	In accordance with ASTM D5206	Resist to wind speed of 110 MPH (177 km/h) minimum (depending on product) *

All testing in accordance with ICC-ES AC308 (Acceptance criteria for polymer siding systems)
Product certified by independent laboratories

* Contact Novik customer service for additional information

Distributed by:

MITTEN®
par/by PLY GEM

1-888-MITTEN4 mittenbp.com

