

The aluminum railing that combines **STYLE, STRENGTH** and **LONG LIFE.**

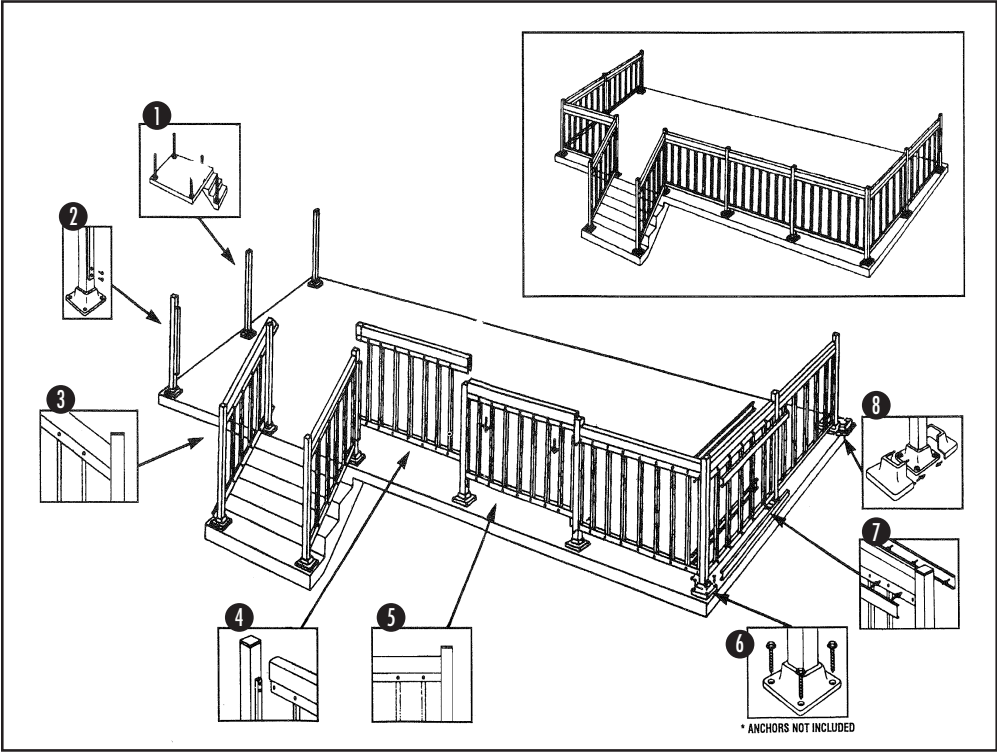

# INSTALLATION INSTRUCTIONS



- 1 Position the posts at the appropriate locations and place the base of the posts at 1½" (½" if post is installed near a wall) from the outside edge of the surface.
- 2 Fix the appropriate spindle fittings to post with ¼" screws. If the surface is not level, you can lower the fittings as needed. **NOTE:** for Post Mounting Spindle, see figure 1.1 and for Angular Adaptor, see figure 1.2
- 3 You need two different posts for a stairway installation: a stair post at the base and a mounting post at the top of the stairway. Do not install the spindle fittings immediately. Simply mark on the post the height where the spindle fittings must be screwed depending on the position of the railing. **NOTE:** For stair post applications see figure 1.1.C
- 4 Join the railing to the fitting system by holding it firmly against the post.
- 5 Fasten the top and bottom railing on each side with ½" screws. **NOTE:** for Glass Railing Systems, see figure 2.1
- 6 When all sections are fastened, you can align and adjust your installation. Fasten each post to the surface using appropriate mounting anchors. **NOTE:** Installation anchors are not included in "any" post package. Speak with a store sales associate concerning available mounting anchor options.
- 7 Once assembly is done, snap the rivet-covers into place and tap with a rubber hammer.
- 8 Complete your installation by installing the base cover caps to the posts.

FIGURE 1.1  
POST MOUNTING SPINDLE INSTALLATION

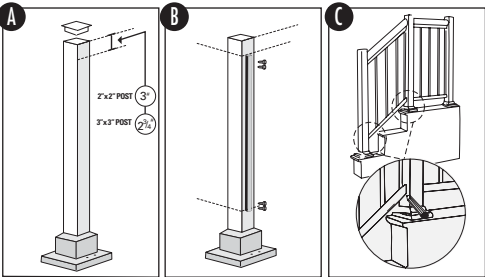

- A** Measure down 3" (for 2"x2" universal post) or 2¾" (for 3"x3" universal post) from top of post and mark with horizontal line. This determines the position of the top of the mounting spindle.
- B FOR HORIZONTAL RAILING APPLICATIONS**  
Align the top part of the spindle fitting to the horizontal lines marked on post. Center spindle fittings by measuring an equal distance between left and right sides of post.  
Mark first hole, drill, and secure spindle with screw. Level spindle, mark next hole, drill, and secure. Do the same for the rest of screws.
- C FOR STAIR RAIL APPLICATIONS**  
The position of the fitting varies depending on the degree of the stairs. You must place the railing and fitting at the height wanted and mark with a pencil the installation height at the bottom of the fitting.  
Place the fitting against the pencil mark, center same and make holes with a ⅛" drill.  
You can now fasten the fitting to the post.

FIGURE 1.2  
ANGULAR ADAPTOR INSTALLATION



**STEP 1:** Place half moons side by side at 1½" for 1500, 5000 and Empire series from top and screw to post or 1" for Imperial series from top and screw to post.

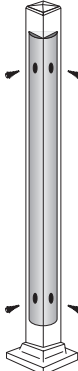

**STEP 2:** Find desired angle and align adaptor and spindle fitting with bottom of half moons. Drill and screw to post.

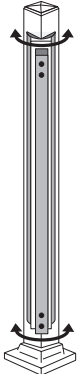
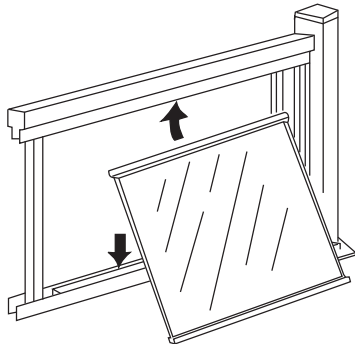

FIGURE 2.1  
GLASS RAILING SYSTEMS INSTALLATION



Once the railing is mounted as normal between 2 posts or 2 walls or combination thereof, the glass can then be installed. The glass is installed in its place by inserting the top of the glass & moulding into the handrail and then lowering it into place onto the bottom support track. Once it is in place and centred, a firm pressure needs to be applied to the glass pushing it down against the bottom track. While the pressure is being applied the glass is anchored into place by using the ½" natural screws (KR7539) by either putting them into the guide holes or by making new holes where required screwing into the handrail and into the top moulding of the glass. (3 to 4 screws should be used depending on the width of the glass.)

Once the glass is installed, the rivet covers can be put on as normal to complete the installation.

# GUARANTEE

## Guarantee Coverage

Only the original consumer buyer receives from Imperial Kool-Ray a guarantee starting from the date of purchase and covering the following points within the normal use of the product:

- Material and manufacturing defect: 20 yrs
- Paint finish parts: 5 yrs
- Plastic parts: 2 yrs

## The Guarantee Does Not Cover

The guarantee is valid for the original consumer buyer only. The guarantee excludes damages caused by a faulty installation, abuse or wrong usage of the product, caused either by the contractor, the service company or the buyer himself. Imperial Kool-Ray cannot be held responsible for labor cost and/or damages incurred during the installation, repair or change, nor for resulting unforeseen damages. Defects or damages caused by the use of parts other than original Imperial Kool-Ray parts cannot be covered by the guarantee as well as the use of an inappropriate anchor to your surface.

## Claims

A replacement part will be supplied free of charge to be installed by yourself. To place a guarantee claim, you have to write to:

## Contacts

40, rue Industriel Park St., Richibucto, NB E4W 4A4  
(T) 1.800.361.3956